

## Product information sheet ELOSCOPE-F II

Item no. 516672

### Benefits

---



- Suitable for installation beneath window
- Clear, uncompromising design for modern kitchens
- Easily hand-operated
- For installation in front of window
- High spout for easier filling of pans and vases
- Only 30 mm min. distance between sink and window aisle
- Uniform tap holes for tap and operating lever

### Colours

---



Available colours:  
chrome

galvanic chrome

## Planning information

---

- Please note:
- High pressure supply only - Min. 1.0 bar pressure (approx 10 metre head) preferred 1.0 - 1.5 bar
- Height: 20-256 adjustable
- Reach: 242
- Base: 52
- Tap hole:  $\varnothing 35 \times 2$
- Installation depth of BLANCO ELOSCOPE-F II: 470 mm (incl. spray hose). Otherwise risk of collision with waste separation system, boiler etc.)
- Min. distance between sink and window aisle 3 cm

## Scope of supply

---

- Spout can be retracted and swivelled by 360°
- 2 x  $\varnothing 35$ mm tap holes required for tap and operating lever
- With ceramic disc cartridge
- Flexible connector pipes, 740mm long and  $\frac{3}{8}$ " nut for particularly easy installation
- Patented jet regulator for markedly reduced scaling
- Requires balanced high pressure supply only, minimum 1.0 bar
- Fit metal stabilising bracket if required, item No. 513383

## Details

---

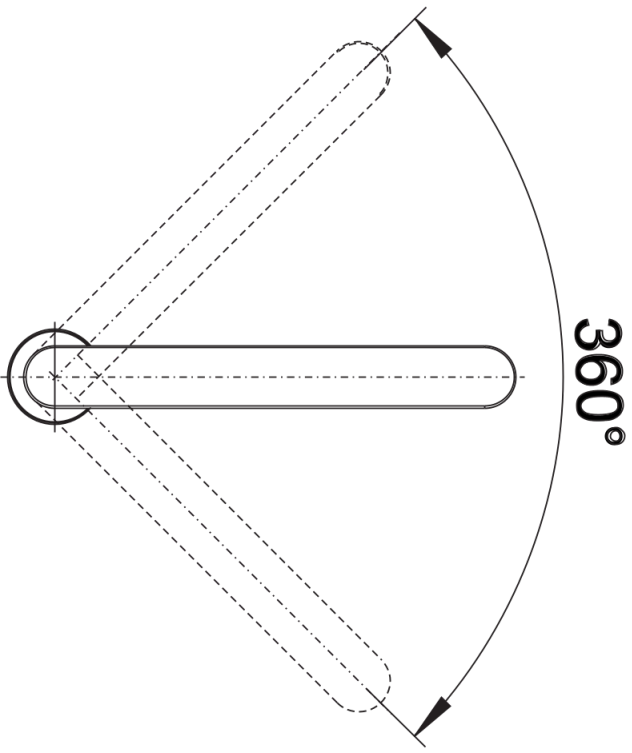

Swivel range

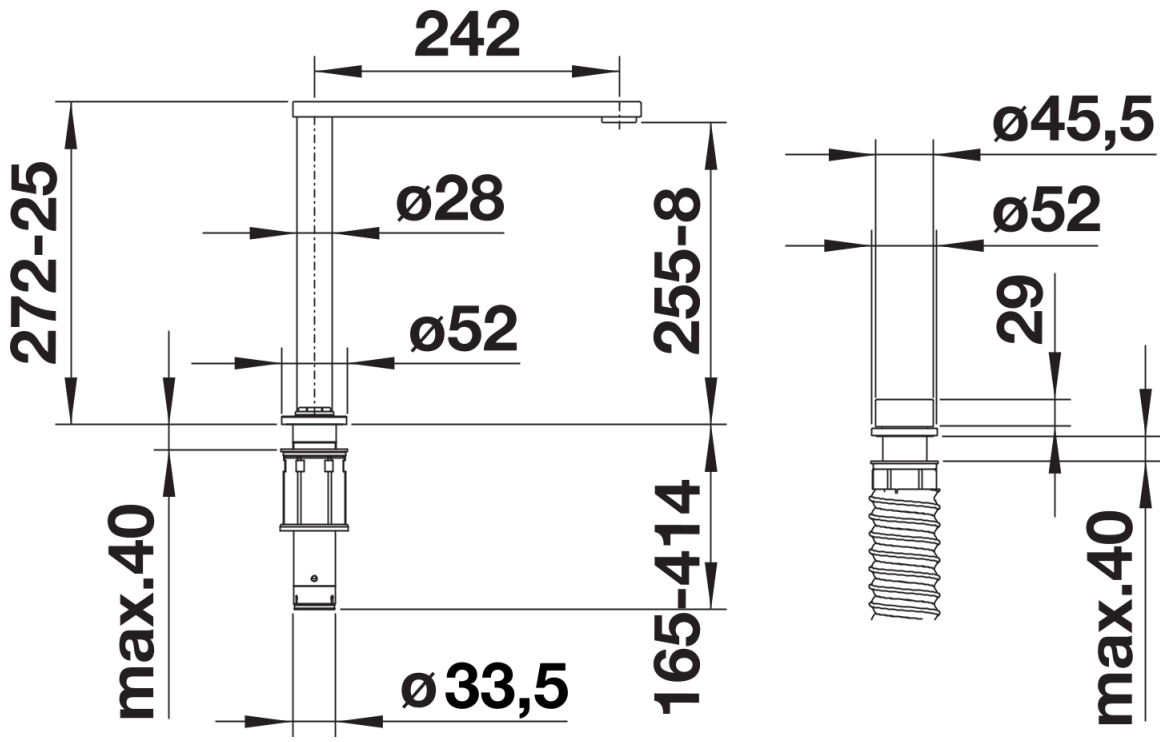

Side view