

## Product information sheet SUBLINE 350/350-U

Item no. 525987

### Benefits

---



- Our versatile SUBLINE kitchen sink range almost wholly vanishes into the undermount, fitting harmoniously into the worktop: a must for minimalist kitchens
- Straight-lined design: timelessly elegant
- Two bowls: soak baking trays in one bowl and leave the other for separate tasks
- Elegant InFino strainer for swift water drainage, less splashing and superfast sink drying

### Colours

---



Available colours:

black  
anthracite  
rock grey  
volcano grey  
white  
soft white  
tartufo  
coffee

SILGRANIT black

## Planning information

---

- Cut out size: 725 x 400 x R10

## Scope of supply

---

- Waste fitting with space-saving pipe
- two 3 ½" InFino basket strainer

## Details

---

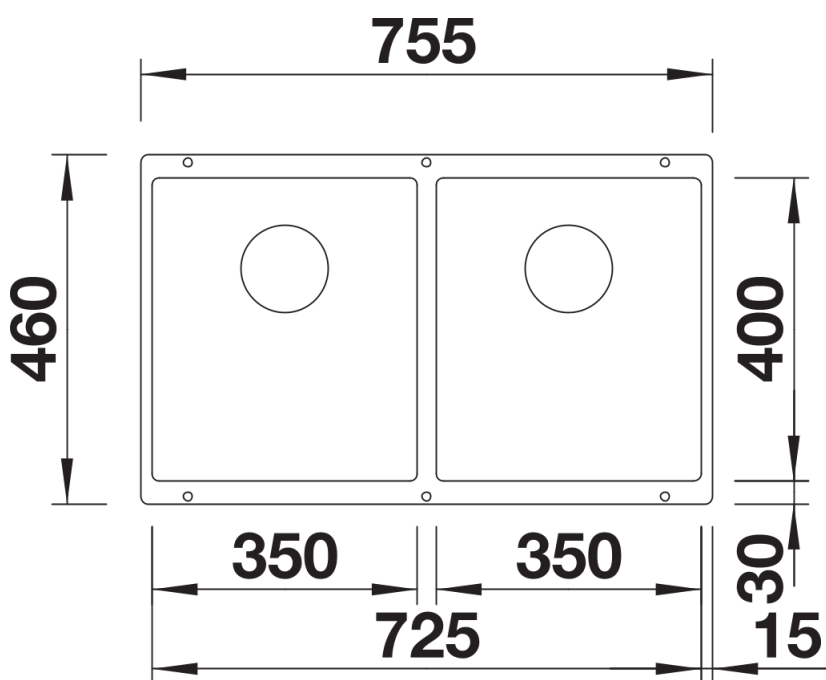

Top view

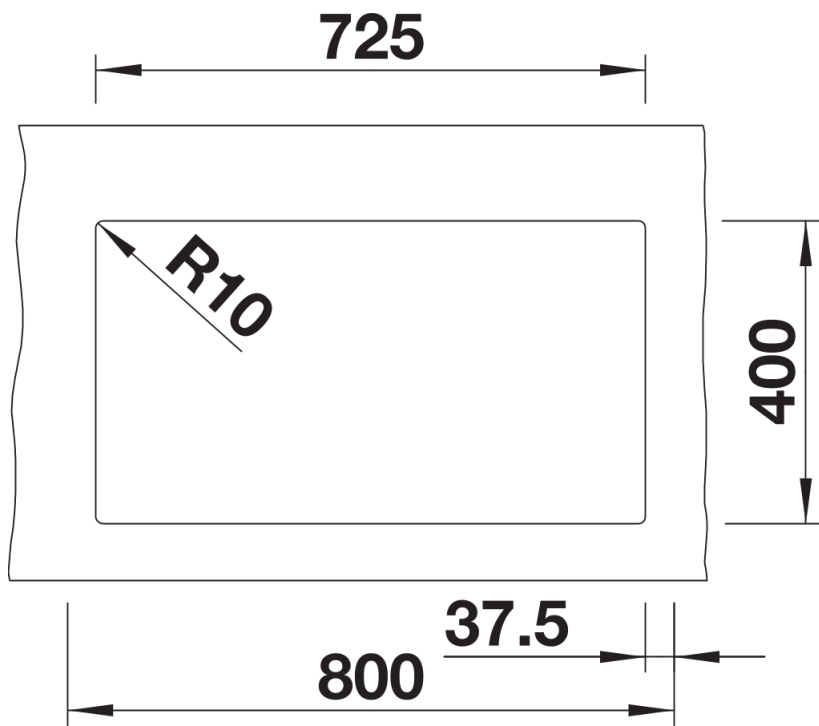

Cut-out

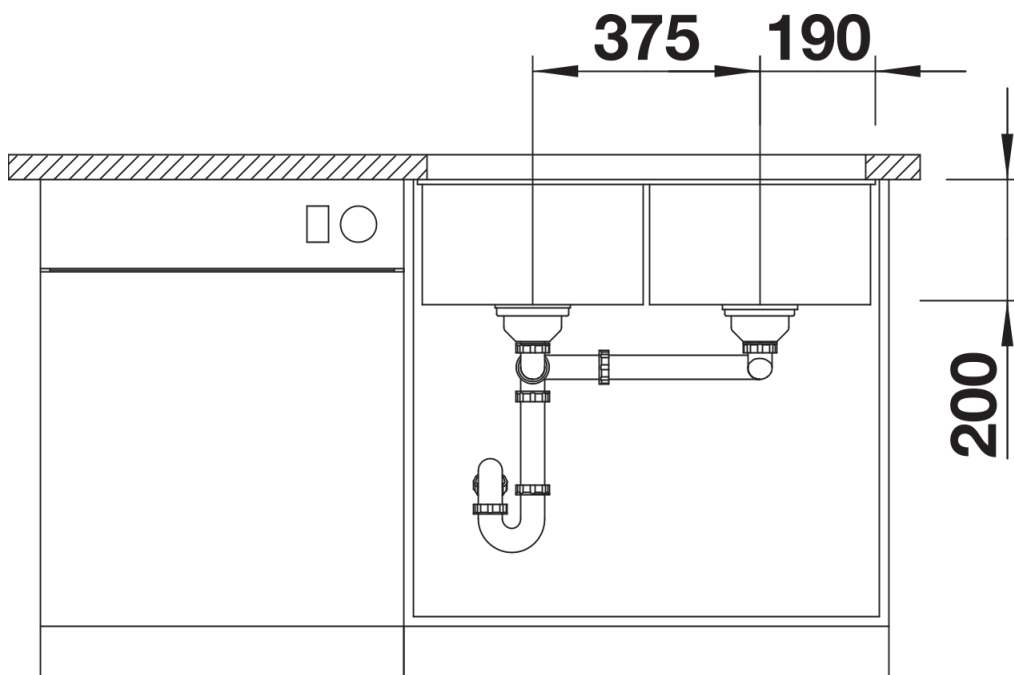

Front view

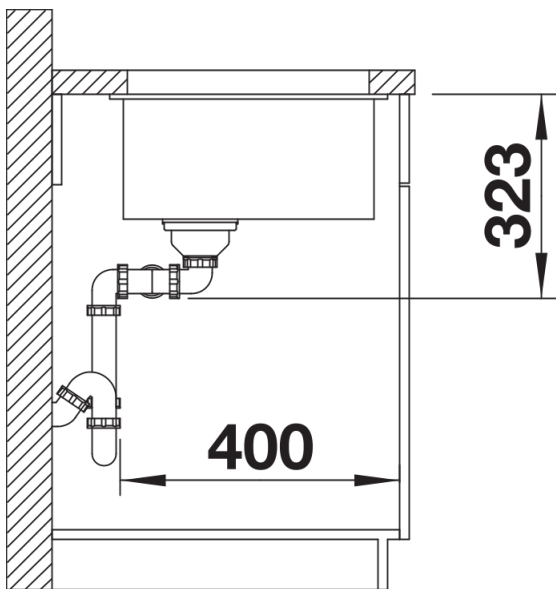

Side view